

THE INFORMATION CONTAINED IN THIS DOCUMENT IS THE PROPERTY OF EEM IT SHALL NOT BE USED, REPRODUCED OR DISCLOSED TO OTHERS IN WHOLE OR IN PART WITHOUT THE PERMISSION OF EEM. ANY MANUAL ALTERATION WITHOUT AUTHORISED SIGNATURE SHALL AUTOMATICALLY RENDER THIS DRAWING INVALID

# SINGLE INLET

Impeller : M.S Powder Coated  
Rotor : Aluminium Casting,  
Powder Coated in Black  
Casting : Aluminium Die Casted  
Insulation : "F"  
Class  
Bearings : Ball Bearing  
Direction of Rotation : Clockwise  
Duty Cycle : SI

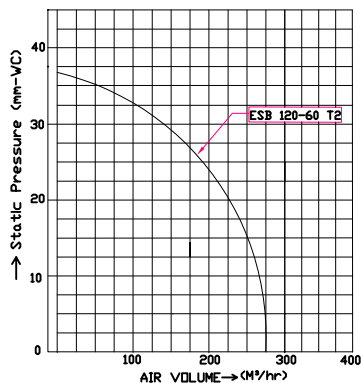
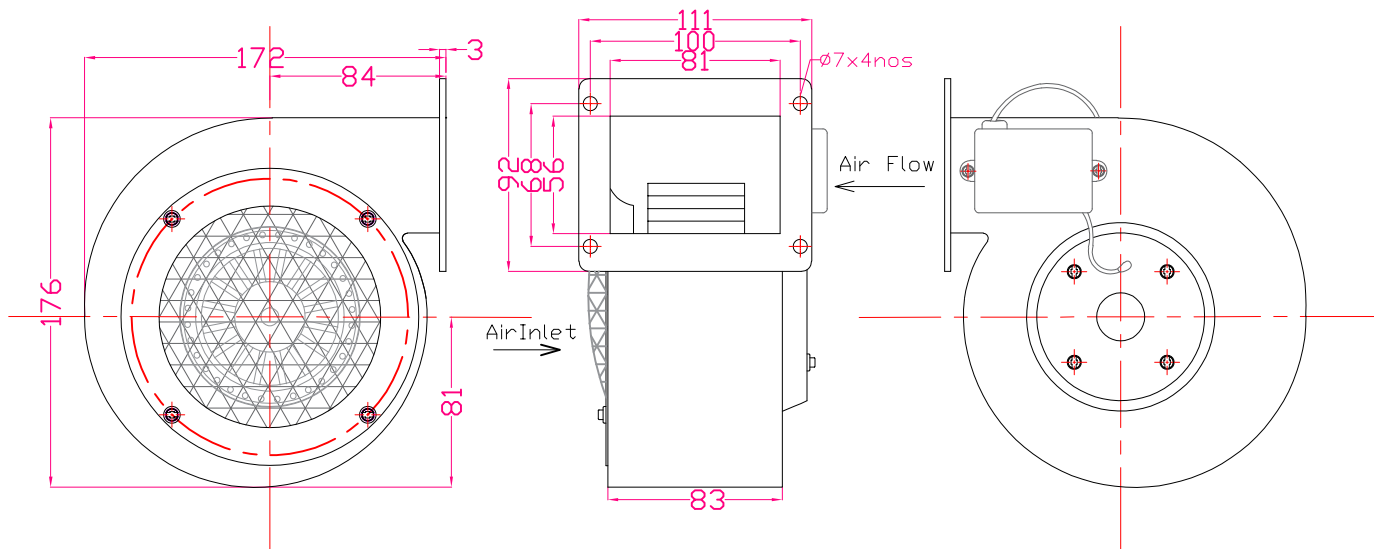

MODEL	ESB 120-60 T2
POLES	2
VOLTAGE (VAC)	415
CURRENT (A)	0.15
POWER (W)	55
SPEED (RPM)	2700
AIRFLOW (M³/hr)	275
AIRFLOW (CFM)	162
NOISE dBA	70
CAPACITOR uf	-
WEIGHT Kg	2.5
TEMP (°C)	60

Motor insulation: Class F  
List of Routine Tests conducted.  
1. Measurement of Winding Resistance.  
2. Measurement of parameter like, Input power, Current, speed and vibration at  
3. Withstand voltage test at 2200V(30), 1500V(10)  
4. Insulation Resistance Test 500V(10)  
The minimum insulation resistance shall be 5MΩ.

**Note:**  
\*All Dimensions in mm  
\*Design specifications and technical characteristics are subject to change without notice.  
\*Air output and pressure data are provided for Reference only  
\*Air output-Conversion to cfm : divide "m³/hr" by 1.7  
\*Due to continuous development, We reserve the right to modify the above details and specification without prior notice



DRG NO. EEM J 23-004  
PL NO. NIL

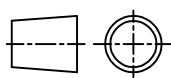

SCALE  
NTS

SINGLE INLET  
Model ESB 120-60 T2

	NAME	SIGNATURE	DATE
DRN	JSV		10-10-2023
CHKD	PSP		10-10-2023
APPD	EKD		10-10-2023

EYYANI ELECTRIC MACHINES PVT.LTD  
BANGALORE 560 058  
www.eyyani.com  
e-mail: Info@eyyani.com